

LYNGSAA®

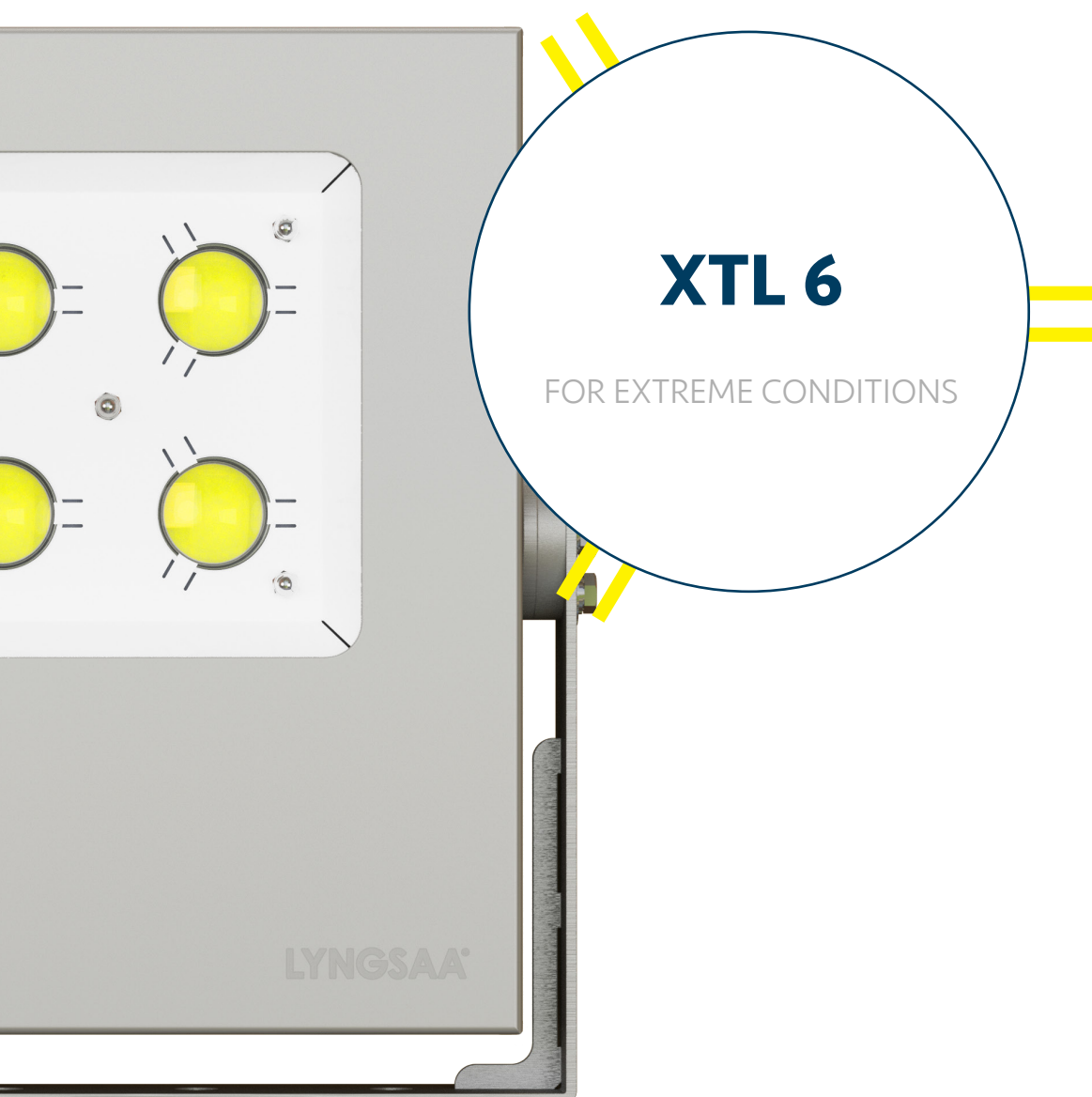

FLOODLIGHT



BACK VIEW



SIDE VIEW



BRACKET

LYNGSAA FLOODLIGHT XTL 6 has countless applications and utilizes the latest LED technology to ensure optimal task lighting in all conditions.



DURABLE

- Resistant to shocks and vibrations
- Resistant under extreme weather and working conditions



LONGEVITY

- State of the art LED and driver technology



LOW ENERGY CONSUMPTION

- Energy savings of approx. 80%



INDIVIDUAL SOLUTIONS

- Can be custom made with brightness up to 18840L

LYNGSAA®



**SOME PEOPLE ARE AFRAID
OF THE DARK
OUR COMPETITORS ARE
AFRAID OF THE LIGHT**

Floodlight - **XTL 6** is designed to be the work- and industrial lamp of the future.

The **XTL 6** is designed with the use of advanced 3D design tools and developed with state of the art LED and driver technology, which together with a rugged housing in pickled AISI 316 stainless steel, marine grade anodized aluminium and tempered glass, ensures a long lasting product.

Equipped with high efficacy LEDs, enabling maximum light output with minimum heat generation, with an energy consumption reduction of 80%, compared with traditional halogen light sources, the LYNGSAA luminaires enable a very short return on investment.

The **XTL 6** can be implemented in all sorts of environments and industries, such as marine & off-shore -, road -, agricultural -, harbor - and building sites, to mention a few.



LYNGSAA®



HIGH QUALITY MARINE & OFFSHORE LIGHTING SOLUTION

TECHNICAL SPECIFICATIONS

Item No.:	101446
Wattage:	95W
Voltage:	100-240VAC, 50-60Hz
Beam angle:	60° /120°
Dimensions:	300 x 335 x 100 mm
IP rating:	IP67
Temp. range:	-35° to +50°C
Weight:	9.25 kg
Warranty:	5 years

LIGHT SPECIFICATIONS: KELVIN(K)/CRI, LUMEN(L)

	70 CRI	80 CRI	90 CRI	HIGH CRI
2700K	NA	13395L	11165L	9792L (97)
3000K	NA	14000L	11580L	10465L (97)
3500K	NA	14370L	12000L	11620L (93)
4000K	NA	14515L	12420L	12430L (93)
5000K	18840L	14950L	12726L*	NA

* Standard models

Technical specifications are calculated on data available from component manufacturers. Lumen/CRI/Kelvin are calculated before optical transmission.

60°

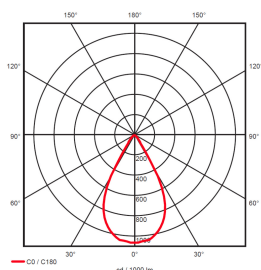

120°

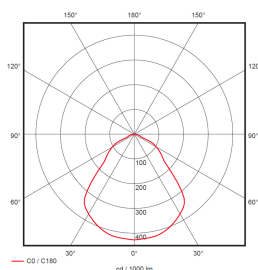

- Marine Grade steel, specially suited for marine environments.
- Exceptional corrosion resistance
- Excellent atmospheric corrosion resistance in polluted marine atmospheres

- Highest quality optical elements, made in Germany
- Specially developed for LED lighting modules
- High efficiency light output

- High quality drivers from MeanWell, a world leading power supply provider
- High performance and lifetime

- High quality Bridgelux elements selected in co-operation with Bridgelux specialists.

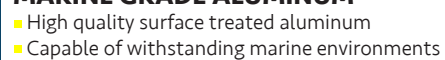

- M20, nickel-plated brass as standard*

*Cabling and Cable Gland options can be provided as per request.

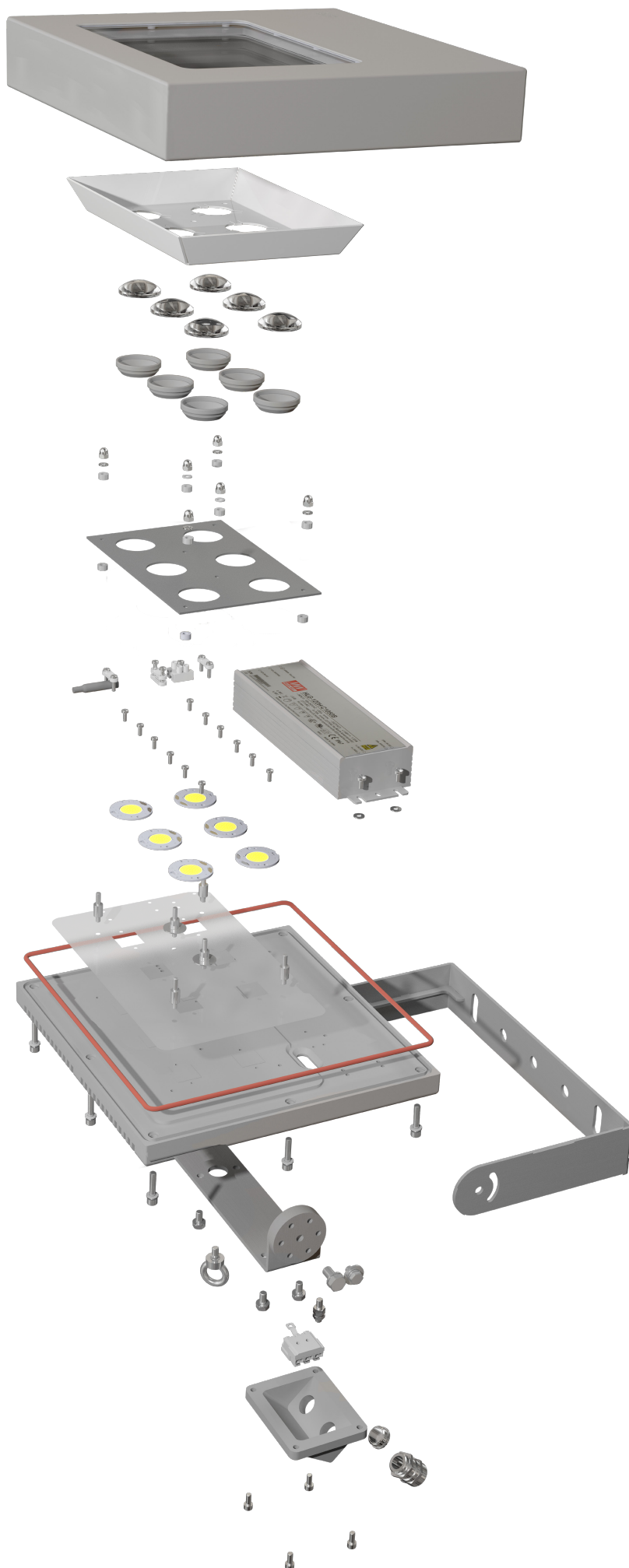

LYNGSAA®

Mission

Our goal at LYNGSAA is to be the leading, global innovator of high-end lighting solutions for extreme environments, providing our customers outstanding illumination and superior service.



Torben Laustsen

LYNGSAA A/S

Nordvej 11
DK-9900 Frederikshavn
Denmark

CVR: 38 15 41 33
Email: info@lyngsaa.eu
Web: www.lyngsaa.eu
Phone: +45 98 46 92 70

